

PART #	A	B	C	D	E
ICD2-MG15	16.92	25.00	30.80	19.20	2.29
ICD2-MG26	25.25	33.30	39.20	27.70	2.29
ICD2-MG44	38.96	47.04	53.05	41.10	2.29
ICD2-MG62	55.42	63.50	69.40	57.30	2.41

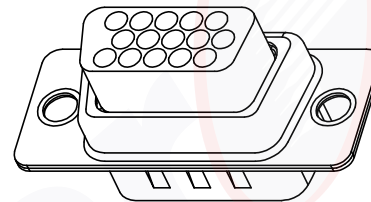
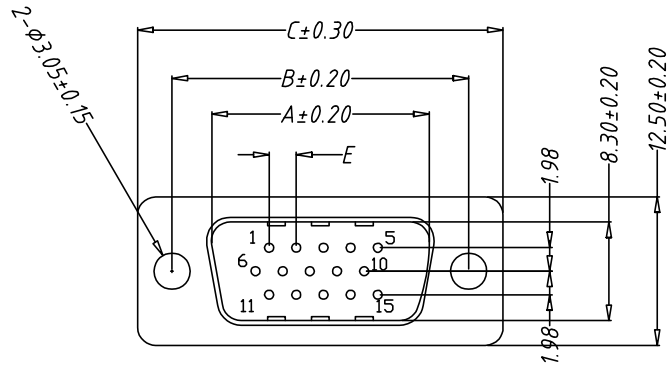

Specification:

Rated Current (MIN): 3A AC. 4 A DC.

Insulation Resistance (MIN): 500 MΩ

Rated Voltage (MIN): 500V AC

Contact Impedance (MAX): 30mΩ

Operating Temperature: -55°C to +105°C

Material:

Insulation: PBT + 30% Glass Fiber UL94v-0

Shell: Steel. t = 0.4mm

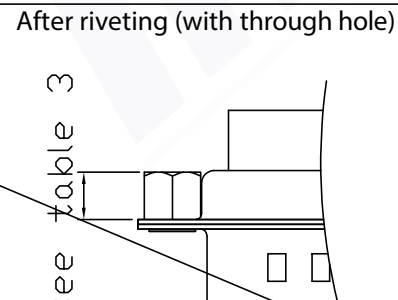
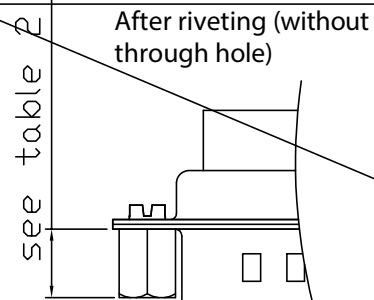

Interface INTERFACE CONNECTRONICS PVT LTD							
Address:#85, Unit#3, 1st Floor, V.V. Yoga Saurabha, S. C. Road, Yeshwanthpur, Bangalore- 560 022.							
Product Specification	2.00mm IDC Socket with Strain Relief, Black						
Part no.	ICD2- MGXX	Version	A0	Proportion			
Customer Code		Customer Part No.		Unit	mm		
Tolerance	X. ±0.50, X. ± 0.38, .XX ± 0.25, .XXX ± 0.13			File No.			
Drawn By	SM	Checked by	RKS	Approved by	YRS	Date	12/3/2019