

PIN CONFIGURATION		
SIDE A	COLOUR	SIDE B
PIN#1	RED	OPEN
SHELL	BLACK	OPEN

**FINISHED GOOD(CA) PART NO: DESCRIPTION**

RCA-9004    XX    01

TYPE OF CA    COLOUR OF CA

RCA-9004: DC JACK STRAIGHT 2.5MM  
OUTPUT CABLE w/ FERRITE CORE w/ GROMMET  
TO OPEN    BLACK

LENGTH OF CA  
0.1 TO XX MTRS

FOR EXAMPLE;  
PART NO: RCA-9004-1-01  
DESC: DC JACK STRAIGHT 2.5MM OUTPUT CABLE  
w/ FERRITE CORE w/ GROMMET TO OPEN  
LENGTH: 1MTR

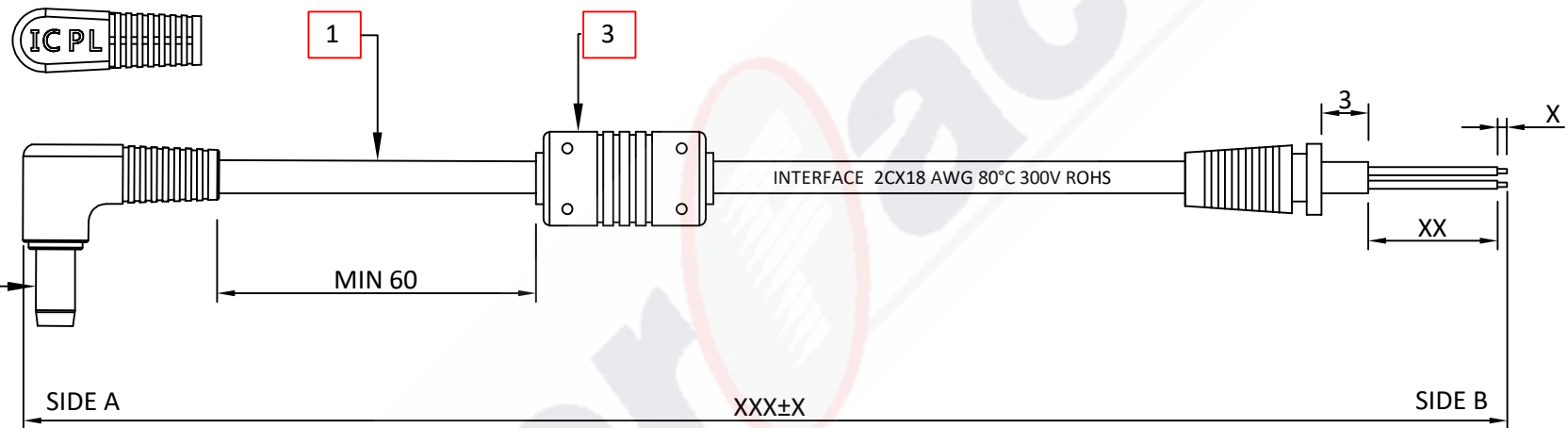

SL NO	DESCRIPTION	QTY
1	41/0.16 2CX18AWG DC JACK CABLE	1NOS
2	DC PIN 5.5-2.5-22.5	1NOS
3	FC 10.5X20X5.5	1NOS

		Description	DC JACK RIGHT ANGLE 2.5MM OUTPUT CABLE w/ FERRITE CORE w/ GROMMET TO OPEN, L-XXMTR		
		Drg No	A4-01-9004-XXX-01		
		ICPL Part No	RCA-9004-XX-01		
Address: B-260,Peenya 2nd stage,Peenya industrial area, Bangalore-560058.		Customer Part No	TBA	Rev	00
Drafted by	MC	Angle of projections	Third angle	Scale	1:1
Checked	RV	Date	11-06-2024	Sheet	1 of 1
Approved	NC	All dimensions are in mm		Size	A4
Tolerance	Unless otherwise specified for length 0 - 500 - ±5      1000 - 1500 - ±15 500 - 1000 - ±10      1500 - 2000 - ±20	*The document is an property of <b>Interface Connectronics Pvt Ltd</b> and is considered company confidential. Reproduction, unauthorised use, or disclosure of this drawing in whole or in part is prohibited.*			

**SIDE A: DC PIN**

CONNECTOR: 5.5\*2.5\*12  
DESCRIPTION: FEMALE BARREL TYPE CONNECTOR  
RATING (AMP): 5A

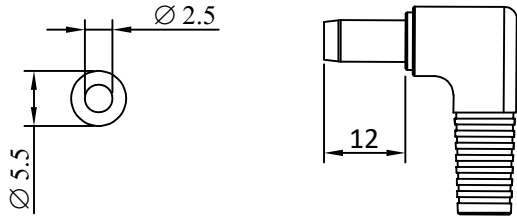

**SIDE B : GROMMET**

CONNECTOR: NA  
DESCRIPTION: OPEN END CONNECTOR  
RATING (AMP): NA

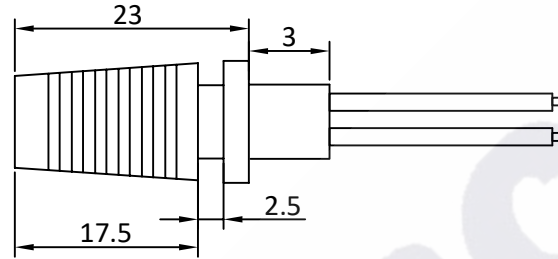

**FERRITE:**

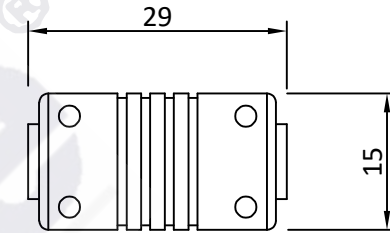

**SINGLE PIECE PACKING DETAILS:**

